



**ARJES  
IMPAKTOR**



**169.500,-€**

# IMPAKTOR **350** EVO II

FLEXIBILITY IN A NEW DIMENSION

[WWW.ARJES-IMPAKTOR.DE](http://WWW.ARJES-IMPAKTOR.DE)

# IMPAKTOR 350 EVO II

## Technical data & performance

Experience the next evolution in shredding technology. Maximum efficiency with minimal maintenance and setup, specially designed for demanding tasks.

### AREAS OF APPLICATION



Waste wood & biomass



Construction & demolition waste



Household & commercial waste

### THROUGH CAPACITY

Construction waste	Ø 96 - 120 t/h
Concrete/asphalt	Ø 72 - 96 t/h
Biomass	Ø 24 t/h
Garbage & plastics	Ø 12 - 17 t/h
Wood waste	Ø 12 - 25 t/h

### HIGHLIGHTS

- ✓ Reversible fan
- ✓ Track system
- ✓ Overband magnet
- ✓ Optional accessories
- ✓ Newly developed control
- ✓ Quick-change cassette & sieve basket

Depending on the shredder's features, shaft configuration, and optimal material feed. All data provided without guarantee.

CONCRETE SHAFTS

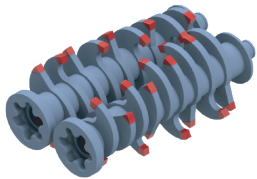

STAR SHAFTS

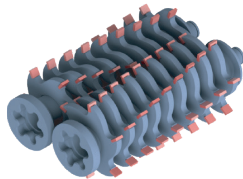

TANGENTIAL SHAFTS

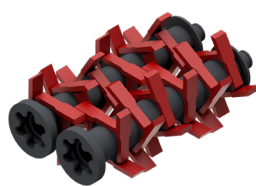

SIEVE BASKET  
CONCRETE

110x60mm | 110x40mm

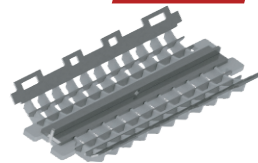

SIEVE BASKET  
WOOD

110x100mm

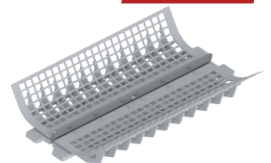

### TECHNICAL DATA

Engine: Volvo TAD 581 VE  
Power: 175kW / 238 PS (EU Stufe V)  
Total weight: 13.400 kg  
Gearbox: Bonfiglioli

Transport dim.: L 7.300 / B 2.300 / H 2.550 mm  
Work dim.: L 7.700 / B 2.300 / H 3.900 mm  
Hopper volume: 2,25 m<sup>3</sup>  
Discharge height: max. 3.200 mm

**MORE  
INFOS &  
DETAILS?**  
SCAN HERE!



**ARJES IMPAKTOR** GmbH  
Werksplatz 2,  
D-36433 Leimbach  
[www.arjes-impaktor.de](http://www.arjes-impaktor.de)

