

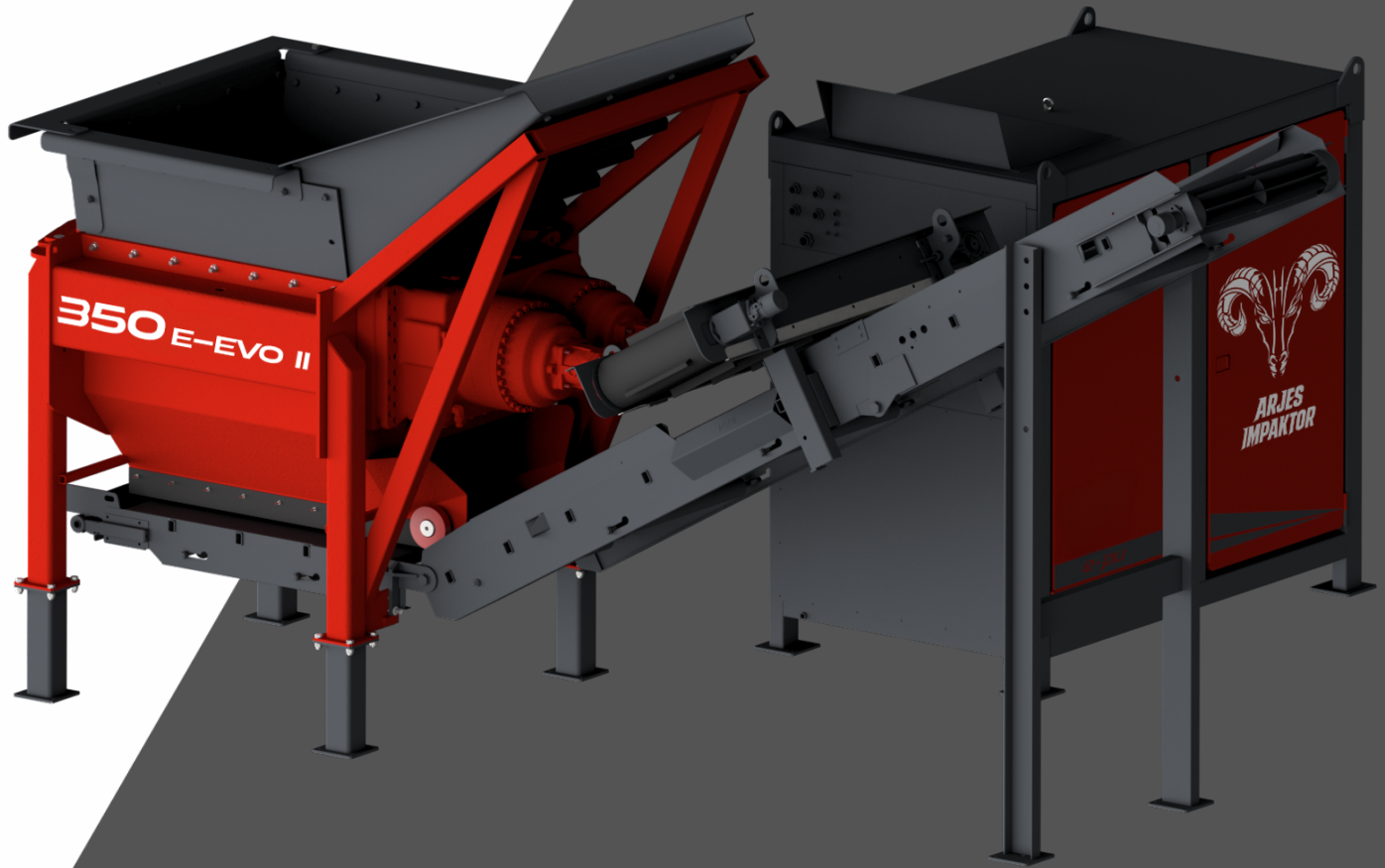

**ARJES**  
**IMPAKTOR**



from **163.800,-€**

# IMPAKTOR **350** E-EVO II

FLEXIBILITY IN A NEW DIMENSION

[WWW.ARJES-IMPAKTOR.DE](http://WWW.ARJES-IMPAKTOR.DE)

# IMPAKTOR 350 E-EVO II

## Technical data & performance

Experience the next evolution in shredding technology. Maximum efficiency with minimal maintenance and setup, specially designed for demanding tasks.

### AREAS OF APPLICATION



Waste wood & biomass



Construction & demolition waste



Household & commercial waste

### THROUGH CAPACITY

Construction waste	Ø 80 - 100 t/h
Concrete/asphalt	Ø 60 - 80 t/h
Biomass	Ø 10 - 30 t/h
Garbage & plastics	Ø 10 - 15 t/h
Wood waste	Ø 10 - 25 t/h

### HIGHLIGHTS

- ✓ incl. Frequency converter
- ✓ Separate drive and control unit
- ✓ Newly developed control
- ✓ Optional accessories
- ✓ Quick-change cassette & sieve basket

Depending on the shredder's features, shaft configuration, and optimal material feed. All data provided without guarantee.

CONCRETE SHAFTS

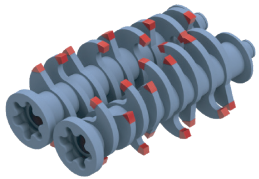

STAR SHAFTS

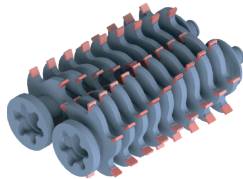

TANGENTIAL SHAFTS

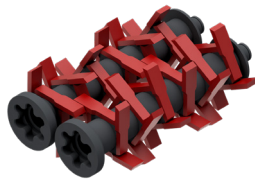

SIEVE BASKET  
CONCRETE

110x60mm | 110x40mm

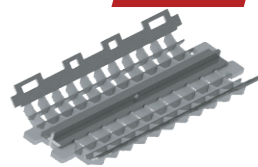

SIEVE BASKET  
WOOD

110x100mm

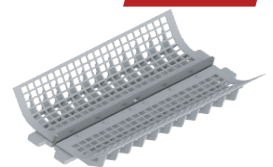

### TECHNICAL DATA

Engine: Elektro

Power: 250kW

Total weight: approx. 15.000 kg

Gearbox: Bonfiglioli

Shredding unit: L 3.300 / B 2.300 / H 3.200 mm

Control unit: L 2.600 / B 1.600 / H 2.700 mm

Hopper volume: 2,25 m<sup>3</sup>

Drop height: ca. 3.200 mm

**MORE  
INFOS &  
DETAILS?**  
SCAN HERE!



**ARJES IMPAKTOR** GmbH  
Werksplatz 2,  
D-36433 Leimbach  
[www.arjes-impaktor.de](http://www.arjes-impaktor.de)

